

## Make & Model

CHEVROLET SUBURBAN 07-13 (Excluding LTZ Model)

## FENDER FLARE INSTALLATION INSTRUCTION

# Item No. 800-0131

### OEM Style

### Parts A - Flares & Rubber Strip



### Parts B - Parts for Installation



**Caution:** Always check the package, ensure the fitment of fender flare and follow the instruction carefully. PSI will not be responsible for painting & other cost incurred to incorrect fender flares, failure of installation, shipping damage or modified flares.

### 1. Pre-Installation



1. Prefit and ensure both left (driver) side & right (passenger) side fender flare to the vehicle before painting or installation.
2. You may remove any moldings, strips or existing flares from the vehicle for fitting and installation.

### 3. Clean Vehicle Body & Fender Flare

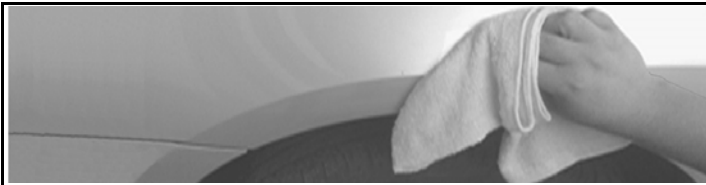

1. Wash and wipe dry the areas of contact on the vehicle body.
2. Clean the surface and inside edge of the fender flare where the rubber seal is to be attached.

### 5. Installation (Left Front Flare Shown)

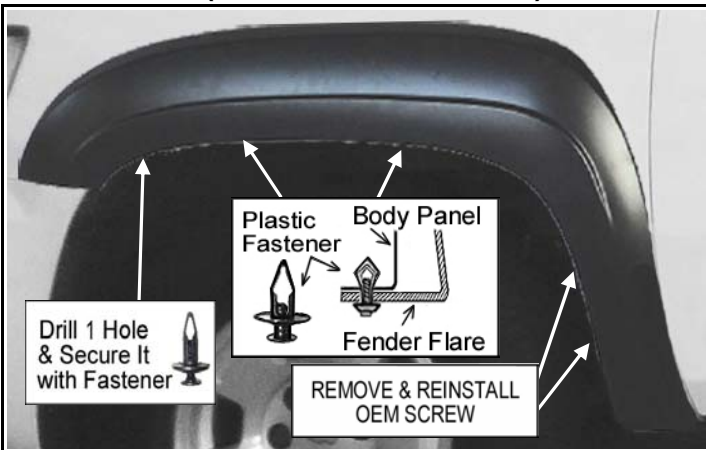

1. Remove and retain 2 existing factory screws on the vehicle .
2. Place the flare on the vehicle with **best position**.
3. Apply 2 Plastic Fastener into the mounting slot on flare and secure it to the vehicle. **(see illustration)**
4. Reinstall 2 existing factory screws removed in step 1.
5. Use a 5/16" bit to drill a hole through the flare & splash shield, align with other factory holes on flare. Apply 1 Plastic Fastener into the hole and secure it. **(see illustration)**

**optional B:** The included self tapping screw may be used for extra secure if needed.

### 2. Paint Flare(Optional)

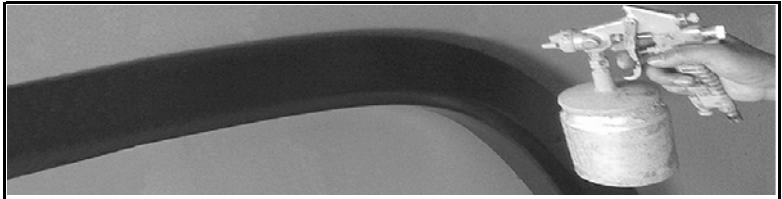

1. Hire a professional painter or body shop and follow the paint manufacturer specifications to paint the flares.
2. Clean all fender flare surface with clean water & a mild detergent before paint, don't use lacquer thinner or any solvent based product

### 4. Apply Rubber Seal

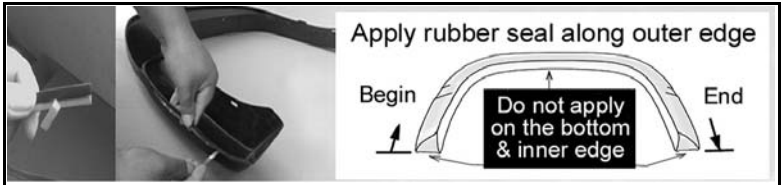

1. Remove 1 inch tape liner from rubber seal, apply it on the flare, start one end & along the edge that comes in contact with body panel. **Caution: 3M tape will stick on the inside of the flare.**
2. Make sure the rubber seal along the edge well, and rip the tape liner off gradually, apply pressure on the tape in the same time to ensure that it adheres well. Trim excess rubber seal and so on.

### 6. Installation (Left Rear Flare Shown)

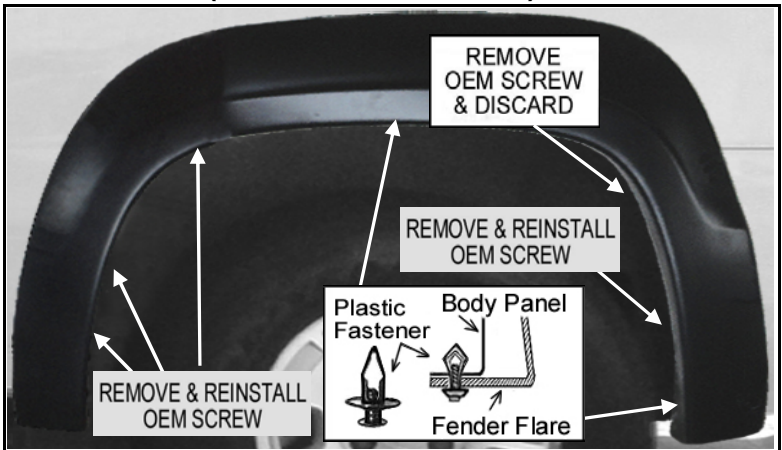

1. Remove 5 and retain 4 existing factory screws on the vehicle .
2. Remove and discard 1 existing factory fastener on the vehicle .
3. Place the flare on the vehicle with **best position**.
4. Apply 2 Plastic Fastener into the mounting slot on flare and secure it to the vehicle. **(see illustration)**
5. Reinstall 4 existing factory screws removed in step 1. **(see illustration)**